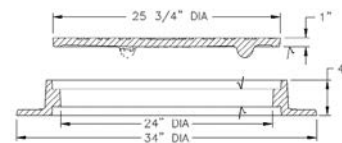

3771 FRAME & COVER

Heavy duty
Machined bearing surfaces
Reversible frame
Accepts 3772 cover

Options
Custom logo covers
Special lettered covers
Solid and vented covers
Gasketed frames
Grates
Ductile iron grates

**3772 FRAME & COVER**

Heavy duty
Machined bearing surfaces

Options
Special lettered covers
Bolted assembly
Grates
4" reversible frame — 3771

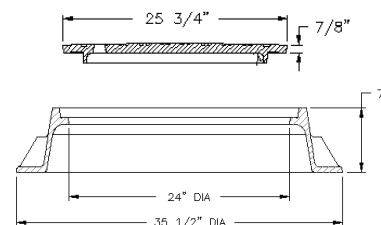
**3773 FROST PROOF FRAME & COVER**

Heavy duty
Machined bearing surfaces

Options
Inner cover — 3773 used
makes unit frost proof

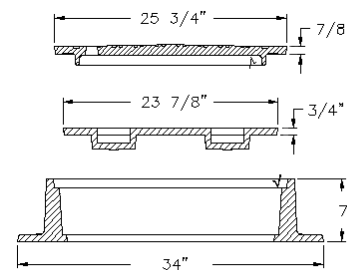

Supplied By:

**TRENCHDRAIN
SUPPLY**

877-903-7246

www.trenchdrainsupply.com